



Naylors

ESTATE AGENTS CHARTERED SURVEYORS



Sheiling House Welford Road

South Kilworth, Lutterworth, LE17 6EA

£3,000 Per Calendar Month

Sheiling House is a charming four-bedroom detached family home. Surrounded by South Leicestershire's open countryside on the edge of South Kilworth, this hidden gem offers an extensive mature garden to the rear and a driveway with a lawn and double garage to the front.



Viewing

Please contact our Market Harborough Office on 01858 450020 if you wish to arrange a viewing appointment for this property or require further information.



Floor Plan

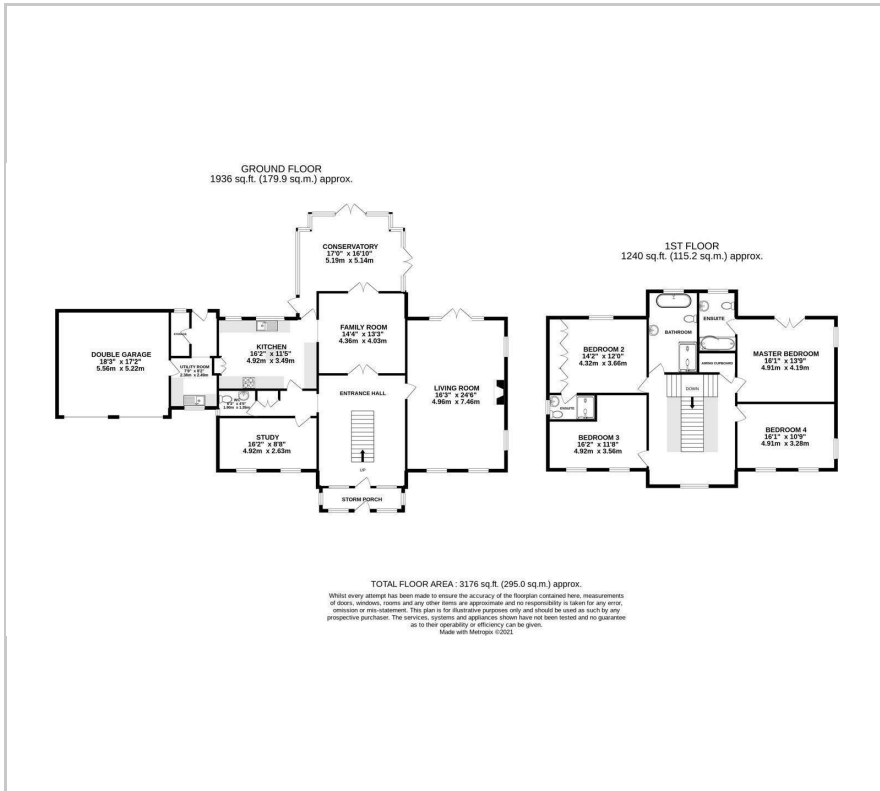

Area Map



Energy Efficiency Graph

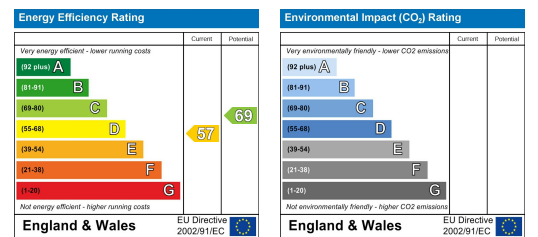

These particulars, whilst believed to be accurate are set out as a general outline only for guidance and do not constitute any part of an offer or contract. Intending purchasers should not rely on them as statements of representation of fact, but must satisfy themselves by inspection or otherwise as to their accuracy. No person in this firm's employment has the authority to make or give any representation or warranty in respect of the property.